

## FEATURES

- Diaphragm operated
- Compact design
- Isolated pressure chambers
- Static pressure up to 100 bar

## APPLICATION

- Filtration plants
- Water applications
- Natural gas processing plant
- Pumps & Compressors
- Clean room applications

### Diaphragm Operated



#### STANDARD PARAMETERS

Accuracy	:	± 2 % (Ascending)
Ambient temperature	:	-40...+65°C
Service temperature	:	80°C max.
Pressure limits	:	Steady pressure up to FS value, No over-pressure

#### MATERIAL OF CONSTRUCTION

Sensing element	:	Diaphragm
Case	:	AISI 304 SS, Push-fit window
Body	:	AISI 316 SS
Dial	:	Aluminum, black graduation on white background
Pointer	:	Fix, aluminum, black powder coated
Window	:	Sheet glass

#### STANDARD SPECIFICATIONS

Dial size	:	DN63 / DN100 / DN150
Range	:	0...75 mbar up to 0...4 bar
Mounting pattern	:	In-line connection
Process connection	:	¼" NPT (F) X 2 Nos.
Ingress protection	:	IP 54
Execution	:	Dry

DIMENSIONAL DRAWING

Type B0

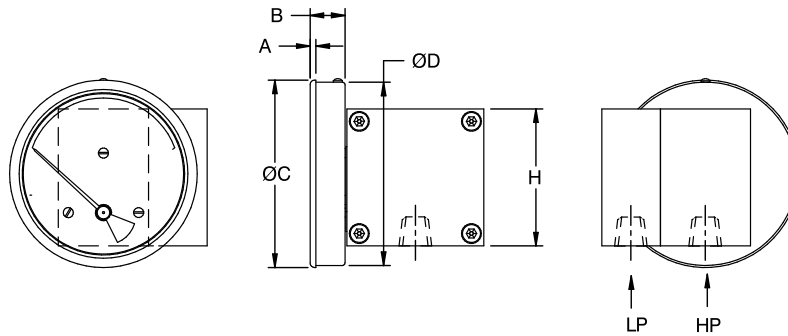

DN	A	B	ØC	ØD	E	H	Weight (grams)
63	2.4	18.6	66.5	63	A/F-20	76	710
100	3.2	19.5	104	102	A/F-20	76	760
150	3.2	19.5	155.5	151.5	A/F-20	76	860

Type R0

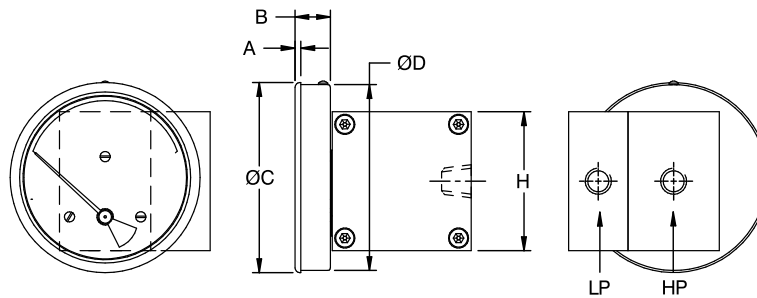

DN	A	B	ØC	ØD	E	H	Weight (grams)
63	2.4	18.6	66.5	63	A/F-20	50	700
100	3.2	19.5	104	102	A/F-20	50	750
150	3.2	19.5	155.5	151.5	A/F-20	50	850

Type X0

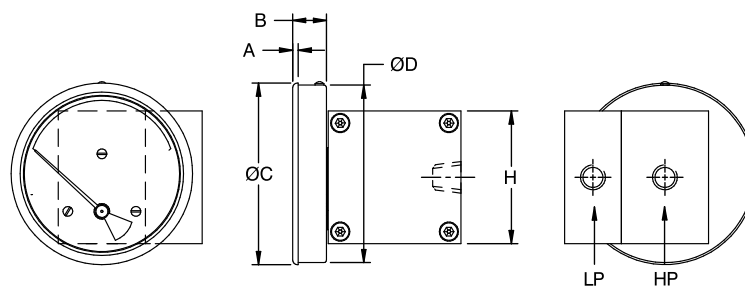

DN	A	B	ØC	ØD	E	H	Weight (grams)
63	2.4	18.6	66.5	63	A/F-20	76	700
100	3.2	19.5	104	102	A/F-20	76	750
150	3.2	19.5	155.5	151.5	A/F-20	76	850

All dimensions are in mm.

## ORDERING CODES

<b>1. DIAL SIZE</b>		<b>25</b>	<b>5. INGRESS PROTECTION</b>		<b>EV</b>	
<b>25</b>	63 mm / 2½"		<b>EV</b>	IP 54		
<b>04</b>	100 mm / 4"		<b>6. EXECUTION</b>		<b>EA</b>	
<b>06</b>	150 mm / 6"	<b>EA</b>		Dry		
<b>2. RANGE</b>		<b>XXX</b>	<b>7. OTHER OPTIONS</b>		<b>XX</b>	
<b>XXX</b>	Refer "Range Table"		<b>TB</b>	Calibration certificate		
<b>3. MOUNTING PATTERN</b>		<b>X0</b>	<b>XG</b>	SS tag plate, AISI 316 SS		
<b>B0</b>	Direct Bottom connection		<b>XF</b>	SS tag plate, AISI 304 SS		
<b>B2</b>	2" Pipe/Yoke mounting		<b>XR</b>	Custom designed dial		
<b>R0</b>	Direct Back connection		<b>XT</b>	Dial tag marking		
<b>X0</b>	In-line connection		<b>GW</b>	Maximum Reading pointer		
<b>4. PROCESS CONNECTION</b>		<b>02N</b>	<b>B7</b>	With 3-Hole front panel		
<b>02B</b>	¼" BSP (F) X 2 Nos.					
<b>02N</b>	¼" NPT (F) X 2 Nos.					

**Ordering Example : P402-25-XXX-X0-02N-EV-EA**

### NOTES

1. For other connections, please contact factory.